



Thank you for considering ELLINGTON PROPERTIES DEVELOPMENT L.L.C for your new home.

We know that choosing the perfect home is a significant and personal journey. As Dubai's leading boutique developer, Ellington has meticulously designed and crafted over 6,000 homes across the Emirates, each tailored to meet the unique tastes and preferences of discerning individuals like yourself.

At Ellington, we don't just build homes; we curate lifestyles. Our commitment to quality, elegance, and sophistication is reflected in every residence we develop, ensuring that your new home is a true masterpiece of comfort and style.

***Disclaimer**

The illustrations in this offer document are for illustrative purposes only. The information contained herein is valid upon receipt by the recipient. Availability of units is subject to change without prior notice. Only the sales and purchase agreement is legally binding. Ellington reserves the right to make modifications to prices, specifications, and availability without obligation or prior notification. Prospective buyers are advised to verify all details independently before making any purchasing decisions



PROPERTY INFORMATION:

City	: Dubai
Community	: Business Bay
Project	: THE CRESTMARK
Building	: The CRESTMARK
Type	: Residential
Configuration	:
Anticipated completion date	: December 30, 2026

UNIT INFORMATION:

Bedroom Type	: 2 Bedroom
Views	: Road View
Anticipated service charge	:
Parking	: 1 parking space
Location map	: View

Floor Plan

All drawings and dimensions are approximate. Drawings not to scale are subject to change without notice. The developer reserves the right to make revisions. The units are taken from the typical floor of the building and columns may vary in size depending on the floor level. The furnishings and accessories shown are representation only. The length and width of the Unit and balcony varies depending on which floor and which orientation the unit is located within the building to comply with the building authority regulations

Schedule 2

UNIT 2002

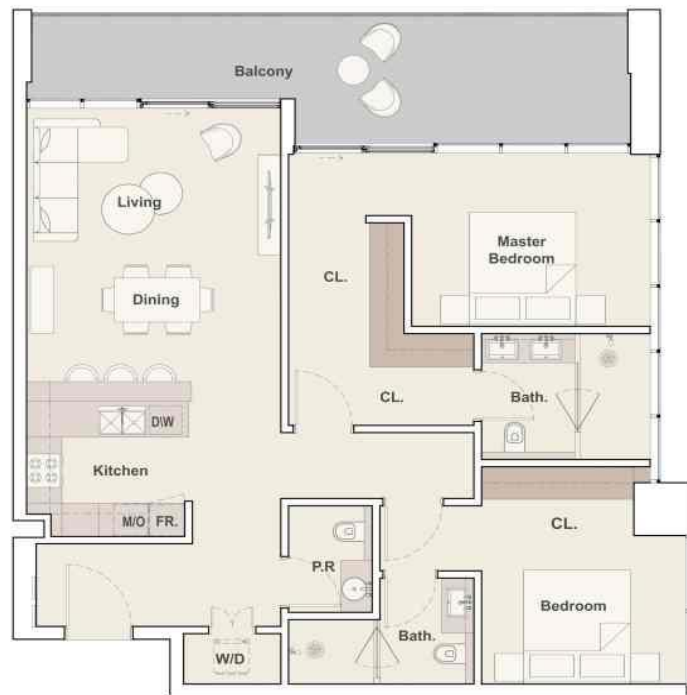

FLOOR PLAN

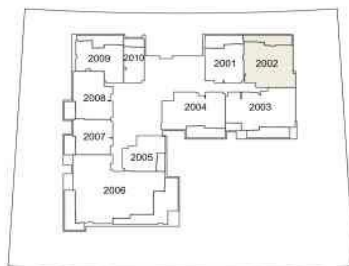

SITE PLAN

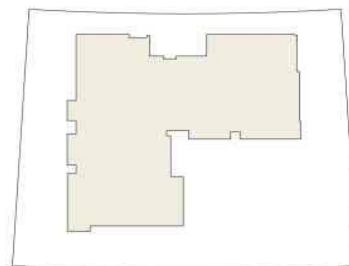

Purchaser's Initials: _____

Seller's Initials: _____

All drawings and dimensions are approximate. Drawings not to scale are subject to change without notice. The developer reserves the right to make revisions. The units are taken from the typical floor of the building and columns may vary in size depending on the floor level. The furnishings and accessories shown are representation only. The length and width of the Unit and balcony varies depending on which floor and which orientation the unit is located within the building to comply with the building authority regulations

UNIT DETAILS

UNIT NO	BEDROOMS	INTERNAL AREA Sq. Ft.	EXTERNAL AREA Sq. Ft.	TOTAL AREA Sq. Ft.	SELLING PRICE
2002	2	1168.21	237.77	1405.98	AED 4,215,828.00

DOWN PAYMENT	20%	843,165.60
REGISTRATION FEE	1,630.00	1,630.00
OQOOD	4%	168,674.88

PAYMENT PLAN

Description	Percentage	Selling Price
On	20%	843,165.60
After 30 Days	10%	421,582.80
After 60 Days	10%	421,582.80
Post 90 Day	5%	210,791.40
After 120 Days	5%	210,791.40
On completion of thirty percent (30%) construction of the Project	5%	210,791.40
On completion of forty percent (40%) construction of the Project	5%	210,791.40
On completion of fifty percent (50%) construction of the Project	5%	210,791.40
On completion of sixty percent (60%) construction of the Project	5%	210,791.40
On Completion	30%	1,264,748.40