



The Crestmark

Business Bay

A modern high-rise building with a glass facade and balconies, illuminated at dusk. The building is situated on a waterfront promenade with palm trees and a walkway. A small boat is visible in the water in the foreground. The sky is a mix of blue and orange from the sunset. The building's base has a sign that reads "ELLINGTON".

A panorama of
glittering water and Dubai's
dynamic cityscape



The Crestmark celebrates the contemporary, promising a bold experience that melds with a serene palette of sophistication in its design. Set within the urban surroundings of Business Bay, it reflects the cosmopolitan lifestyles of its residents, whilst introducing pockets of calm through greenery and natural finishes.

The balance of well-being in bustling city centres is represented in the holistic development, which utilizes cozy timber hues and elevated materials to cocoon and welcome you into a refuge of relaxation. A place where you can make your own and find your corner of the city, The Crestmark embodies the vibrant energy of Ellington.

Scenic views of Business Bay Marina
and Dubai Water Canal



DRIVING
DISTANCES

02
MINUTES
Business Bay Marina

05
MINUTES
Business Bay Metro Station

05
MINUTES
Dubai Mall / Burj Khalifa

08
MINUTES
Dubai Opera

08
MINUTES
City Walk

09
MINUTES
Dubai Design District

10
MINUTES
Museum of the Future

12
MINUTES
Meydan Golf Course

14
MINUTES
Dubai International Financial Centre

14
MINUTES
Dubai International Airport

15
MINUTES
Mall of the Emirates

17
MINUTES
La Mer Beach

19
MINUTES
Dubai Creek Golf & Yacht Club

20
MINUTES
Palm Jumeirah



The Lobby

A breathtaking double-height atrium space welcomes you with a sense of grandeur in the lobby. Soft curves follow the reception desk and metal screens, connecting movement between spaces with a seamless flow.

At the heart is a sculptural Bonsai tree inspired by a biophilic approach that brings the outside in, and provides an inviting environment to linger and stay for moments of social interaction or to work in a nurturing area for productivity.





Welcome to a property at the nexus of natural calm and urban vitality. Inside, residents can find balance from the comfort of home which follows neutral tones and a sophisticated colour palette.

Bringing together textures of metal, glass, and timber, the subtle elegance of the building is complemented with compositions of art. The Ellington Art Foundation has partnered with local artists and artisans to commission a bold collection of tonal art pieces throughout the development.

The signature piece will define a distinct place for those who thrive in the cultural magnetism of Dubai.

Library Lounge



Kidtropolis World



The Kidtropolis on the Ground Floor brings a world of play to life for children in a safe environment for learning.

Themed spaces including a car shop, grocery, hair salon, barber, and diner cafe create imaginative urban settings for the little ones to interact with others and pick up grooming and social skills. Adults can sit on benches within a park-like setting to watch or supervise their young close-by.

The Club Room

Behind a framed piece of artwork, access to the Secret Club Room is hidden and sparks an element of surprise to ignite a sense of discovery in everyone.

Vivid neon signages beyond the door signpost the entry into the Secret Club Room or Arcade Room. A metal mesh curtain that conceals the spaces draws you into a bookable function space with a lounge and dining area to seat up to 10. Coupled with a bar area furnished with an entertainment kitchenette, the space is fit for parties and catering. Overlooking a Private Garden that showcases kinetic artwork, a direct walk-out allows residents to find peace around every corner.



The Arcade

A retro Arcade Room with gaming machines such as skee ball, street basketball and pacman imbues feelings of nostalgia. With an elevated mini-bowling alley, table tennis, and TV gaming area, the activity-filled space is ideal for those who seek fun in their lives.

The area is accompanied by lounge seating as well as a direct connection to the garden and pool.



The Alley

With direct access to the garden courtyard, it serves as the perfect spot for the city dweller that aspires for a perfect balance of life in an urban oasis.

Bring the energy and excitement to your home with our indoor mini bowling alley. Experience life in the fun lane with friends and family here, which promises enjoyment for all.



Fitness Studio

The Fitness Studio reinstates the importance of well-being in busy urban lifestyles, allowing you to work on your body and health while overlooking the landscaped pool area.

Fit for you and suited around varied training activities, the gym consists of precision state-of-the-art gym equipment, a rotating climbing treadwall and a zoned functional training rig.



Mind body and soul

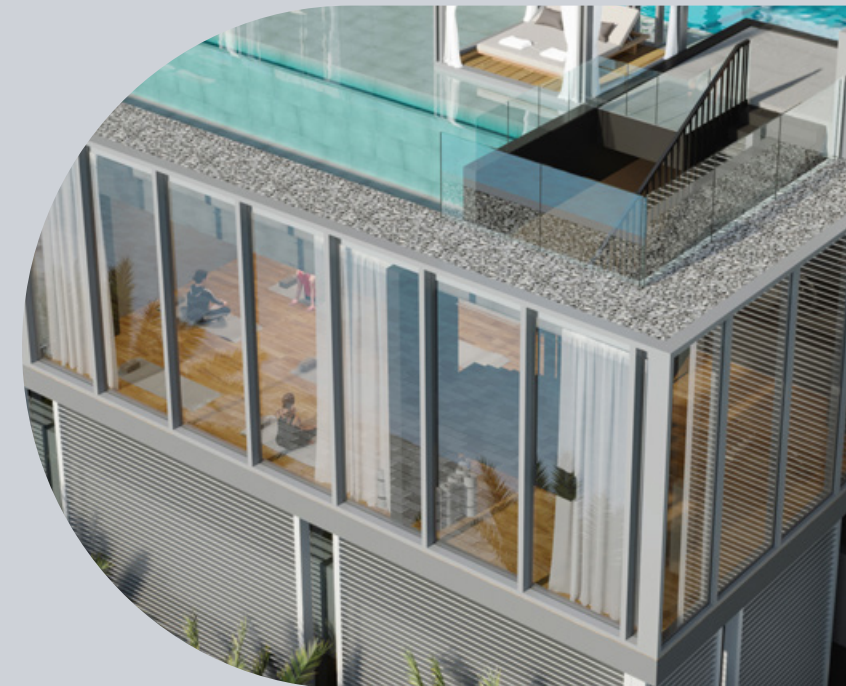

Urban harmony comes together in the Yoga and Zen Room, which is tucked away in a quiet area, accessible through a path that leads down a staircase from the edge of the outdoor pool.

A raised meditation space overlooking the pristine water of the canal is poised for residents to connect with unobstructed views and the flow of nature outside. Textured wood flooring, acoustic ceilings, upholstered cushions and sheer drapes add an aspect of softness to this restorative haven.

The Pool

The resort-style 23-metre swimming pool and outdoor decks are thoughtfully designed to encompass leisure at the core of the community.

A Baja shelf with cabanas and ample hospitality-grade cushioned sun loungers allow for moments of relaxation within the robust landscape.



